

Laser Barcode Scanner User Manual



Factory Default



Version V5.8

Introduction

This is a easily use manual for laser barcode scanner , if you need the more details about how to use , please download from our official website or get the manual from distributors.

Installation

☑ keyboard wedge cable install

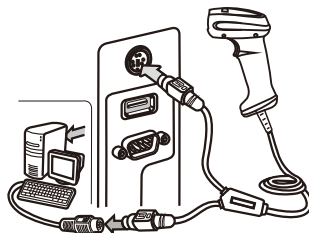

keyboard wedge cable install

☑ RS-232 Cable install

1. Turn off the power supply
2. Put the DB9 connector connection with the device interface.
3. If the device (The 9th pin of serial) can not working , please connect the 5V power supply with cable.
4. Turn on the power .if the buzzer and LED light release the signal, so the the device is working normal.

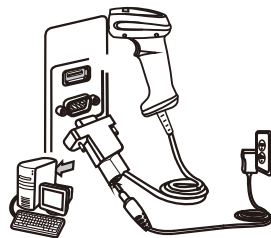

RS-232 Cable install

☑ USB Cable install (put the cable insert the USB serial directly, The Computer will detection and identification automatically)

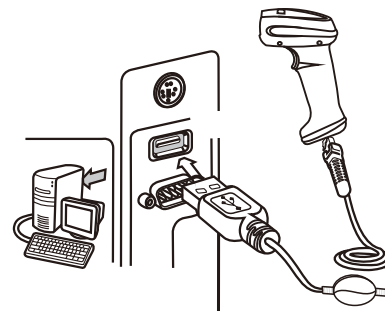

☑ Accessories: Bracket install

1. Use the bracket connector connect to the main body of bracket.
2. Main body of bracket.
3. Philip's screw, Dimensions: M6*10MM
4. Base Support
5. Direct wedged in the base of bracket when the head of bracket and main body connection well.

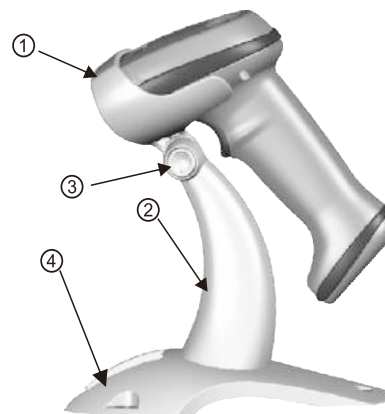

Interface Choose



USB-HID Model*



Ps2-Keyboard Model



USB-COM Model



COM-RS232 Model

Scanning Type



Automatic successive scanning mode



Automatic flashing mode

Buzzer



Sound OFF



Sound ON

Barcode Display Tybe



Display barcode type after barcode



UN-Display type after barcode

Keyboard Model

☐ Language Choice



USA



German



France

☐ Keyboard Caps Lock control



Resume



Capitalize



Lower case

COM Model

☐ Baud Rate



4800



9600



19200



38400



57600



115200

☐ Prefix&Suffix Setting



AddPrefix



AddSuffix



Hide Before
Character



Hide After Character

Special Code ON



CODE11



CODE 39



FULL ASCII



CODE 93



CODE 128



CODE 128ISBT



CODEBAR



Enable Interleaved
2 of 5



Industrial 2 of 5



Matrix 2 of 5



CHINA POST CODE



MSI CODE



UPC-A



UPC-E



EAN-13



EAN-8

☐ Suffix & Skip Setting



CR



LF



CR&LF



Tab



Space



None

Wireless Setting



RF Model



Delete Add



Setting DeviceADD



01



02



03



04



Pairs Add



Inventory Mode



Upload New Data



Upload All Data



Upload Statistic Data



Clear

McGrp.Ru



Сайт техники и электроники

Наш сайт McGrp.Ru при этом не является просто хранилищем [инструкций по эксплуатации](#), это живое сообщество людей. Они общаются на форуме, задают вопросы о способах и особенностях использования техники. На все вопросы очень быстро находят ответы от таких же посетителей сайта, экспертов или администраторов. Вопрос можно задать как на форуме, так и в специальной форме на странице, где описывается интересующая вас техника.